

mpower® Fascia 3" Light



Bright, flexible, available in hundreds of configurations



Screw Mount



Quick Mount



Stud Mount

FEATURES



- First extremely compact, tri-color line of perimeter lighting on the market
- Design and mounting options allow for application nearly anywhere on a vehicle
- Patented, one-piece silicone lens and optic design delivers advantages over conventional polycarbonate lenses
- Highly resistant to UV light and harsh chemicals—achieving greater clarity when exposed to sunlight
- Great resistance to gravel pitting, scratching or cracking
- Superior sealing to prevent water from entering light
- Small footprint with maximized candela output

SPECIFICATIONS

LED Color Capabilities	Single, dual, tricolor
LED Color Options	● ● ● ● ○
LED Count	Single - 4 & 8 LEDs, dual - 8 LEDs, tricolor - 12 LEDs
Flash Patterns	15
Light Sync	Up to 24 lightheads (Sync 2)
Dimensions	4.07" L x 1.5" H x 0.43" D (10.34 cm L x 3.6 cm H x 1.09 cm D)
Mount Types	Quick, screw or stud mount
Certifications	SAEJ595, SAE J845, CA Title 13, ECE R65, ECE R10, NFPA 1901
Warranty	5 year

MOUNTS & DIMENSIONS

STUD MOUNT

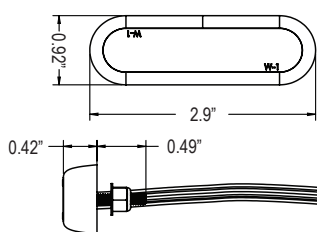

QUICK MOUNT

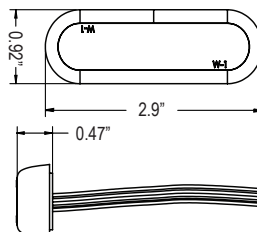

SCREW MOUNT

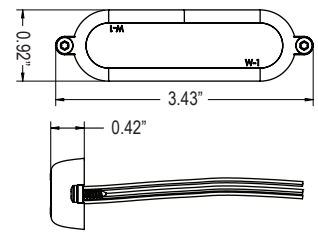

Scan to order
or learn more

Refer to soundoffsignal.com for standard part numbers and complete offerings.

CONTACT

Toll free 800.338.7337
Direct 616.896.7100
soundoffsignal.com

PO Box 206
Hudsonville, MI 49426
customerservice@soundoffsignal.com

V0224